

## AutoSet™ VFD Split Core Current Switch

- Self-calibrating for proof of flow
- 0.5-135A range
- N.O. 30VAC/DC or 120VAC output
- Optional command relay



Patent Pending

### DESCRIPTION

The AutoSet™ VFD line self-calibrates to detect belt loss on motors operated by a variable frequency drive. The C-2350VFD line's microprocessors automatically set the proper threshold - no false alarms with varying frequencies. Sensor will detect motor undercurrent conditions such as belt loss, coupling shear, and mechanical failure on fans and pumps while reducing installation time.

### APPLICATIONS

- Detecting belt loss, coupling shear, and mechanical failure on variable frequency drives

## FEATURES AND BENEFITS

### Self calibration for proof of flow on fans and pumps

- Works without costly "training" of sensor—our sensors are just plain smarter!
- No need to open hot starter enclosures—save on labor as well as improve safety
- Only VFD sensor line capable of functioning on VFDs to 0.5A
- Sensor is always properly adjusted—no call backs
- Push-button and LED interface:
  - Slow blink = normal operation
  - Fast blink = alarm
  - Fast learn mode (optional): Press/hold button 1 second, LED makes 2 fast blinks.
  - Go/No mode (optional) : Press/hold button 5 seconds, LED makes 3 fast blinks.

### Split-core with optional command relay

- Easy installation and provides stop/start/status in a unitary device—saves component and installation space/cost

### Maintenance-free—no call backs

### Save time and money

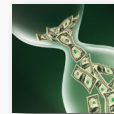

Save up to 15 minutes per sensor install (based on field productivity tests.)

### SET POINT OPERATION

#### Positive proof of flow for VFD driven fans and pumps

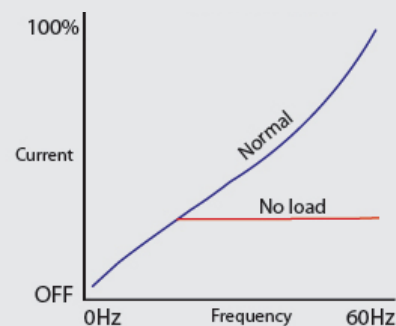

7 year limited warranty

## SPLIT CORE C-2350VFD

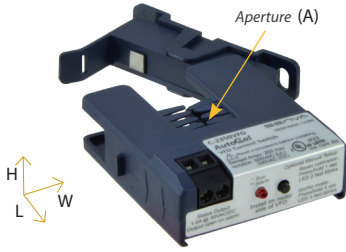

L: 2.5" H: 0.57" W: 2.23"  
A: 0.75" x 0.75"

- Mount sensor without removing conductor for installation savings
- Clamp on conductor with iris, or use detachable base to screw or DIN mount
- Larger 0.75" aperture accommodates oversize conductors

## SPLIT CORE C-2350VFD-L for fractional and small HP VFDs

Note: 3-wire device



## OPTIONAL RELAY



L: 0.84" H: 0.72" W: 2.06"

- Add to 2350 series to get start/stop/status in a single device
- Reduces the number of installed components... saves time and space
- Removable relay facilitates service

## ORDERING INFORMATION

SPLIT CORE	Min (on)	Max A	Output*	Sensor Power
C-2350VFD-L	0.5A	15 A	1.0A@30VAC/DC	12 to 30VDC/ 24VAC
C-2350VFD	3.5A	135A	1.0A@30VAC/DC	Induced
C-2350VFD-HV	3.5A	135A	0.2A@120VAC	Induced

## SPECIFICATIONS

Standard Output Rating	1.0A@30VAC/DC
Line Voltage Output Rating	0.2A@120VAC (-HV MODEL ONLY)
Output Type	NO, solid-state FET
Temperature Rating	-15-60 °C
Insulation Class	600V RMS. For use on insulated conductors only! Use minimum 75 °C insulated conductor
Frequency Range (C-2350VFD)	20-60Hz; proof of flow loss alarm at 50Hz+
Frequency Range (C-2350VFDHV)	20-60Hz; proof of flow loss alarm at 50Hz+
Frequency Range (C-2350VFD-L)	5-60Hz; proof of flow loss alarm at 50Hz+

## COMMAND RELAY

### Contact rating

### Coil

CR3-24	N.O. 10A @ 125VAC	24VAC/DC 15mA nom.
CR4-24	N.C. 10A @ 125VAC	24VAC/DC 15mA nom.
CR3-12	N.O. 10A @ 125VAC	9-12VDC 30mA nom.
CR4-12	N.C. 10A @ 125VAC	9-12VDC 30mA nom.

## 2350VFD-L 3-WIRE FOR MICRO VFD APPLICATIONS

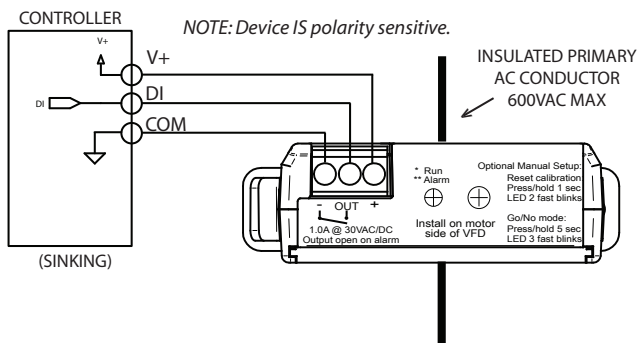

**Warning:** Refer to installation instructions that accompany product and heed all safety instructions. Do not rely on current status LED to indicate presence of power.

## WIRING FOR C-2350VFD

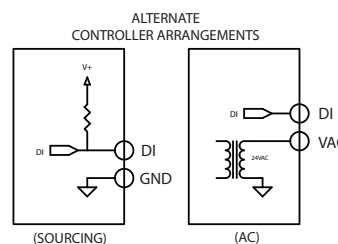
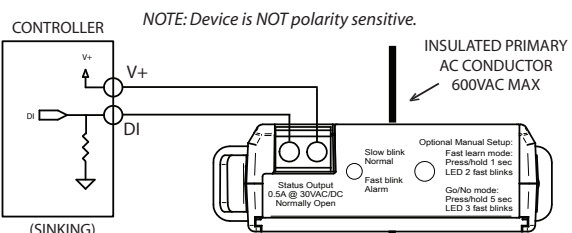

**AutoSet™**